

## O682P

Ballast Type: Electromagnetic  
 Input Voltage: 120Vac +5%,-10%  
 Input Frequency: 60Hz

Starting Method: Preheat Start  
 Lamp Connection: Series

Unit Color: Raw  
 Unit Weight: 0.30 lbs.

### ELECTRICAL SPECIFICATIONS:

Line Voltage (V)	Lamp Type	Lamp Wattage (W)	No. of Lamps	Line Current (A)	Input Power (W)	Power Factor	Max Current THD (%)	Current Crest Factor	Ballast Factor	B.E.F.	Wiring Diagram
120	CFT9W/G23*, CFQ9W/G23*	9	1	0.14	9	≥0.55	≤15	≤1.7	0.80	8.89	101
120	CFT7W/G23*	7	1	0.16	10	≥0.50	≤15	≤1.7	0.90	9.00	101
120	CFT5W/G23	5	1	0.18	9	≥0.45	≤15	≤1.7	1.00	9.00	101
120	F8T5	8	1	0.14	9	≥0.55	≤15	≤1.7	1.01	11.56	001A
120	F6T5	6	1	0.15	10	≥0.50	≤15	≤1.7	0.94	9.40	001A

\* Primary Lamp Type

### PERFORMANCE:

- Electromagnetic Reactor Type Ballast
- Preheat Start
- Series Operation
- Normal Power Factor
- Normal Ballast Factor
- Clamped Core and Coil
- Sound Rated A
- Meets ANSI Standard C82.1 for Ballast Requirements

### APPLICATION:

- Maximum Case Temperature 194°F/90°C
- Maximum Ambient Temperature 104°F/40°C
- Minimum Starting Temperature CFL 0°F/-18°C
- Minimum Starting Temperature Linear 50°F/10°C
- Remote Mounting 10 ft. Max. Lead Length, 18AWG

### SAFETY/STANDARDS:

- UL/935 Listed (Class P, Type 1 Outdoor)
- RoHS Compliant
- No PCB's
- Auto Reset Thermal Protection

### CASE STYLE: CS-01B

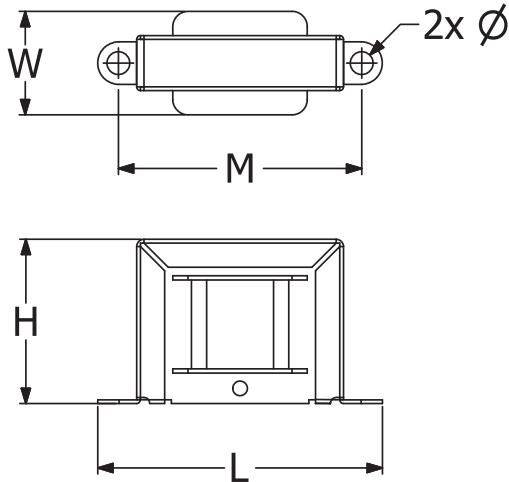

L	W	H	M	$\phi$
2-3/8	15/16	1-3/8	2	3/16
2.38	0.94	1.38	2.00	0.19
6.03 cm	2.39 cm	3.49 cm	5.08 cm	0.47 cm

### WIRING DIAGRAM:

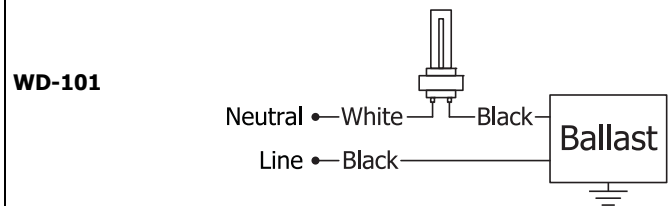
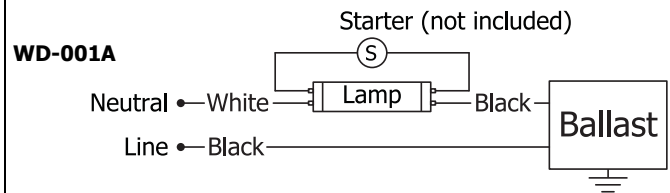

Ballast lead connections are interchangeable

#### Version /A

- Black: (2) 8"
- Tolerance: +1.00, -0.50"
- Strip: 0.375" ± 0.060"

#### Version /D

- Black: 7", +1.00, -0.50"
- Black: 60", +2.00, -1.00"
- Strip: 0.375" ± 0.060"

### WARRANTY:

Robertson Worldwide warrants to the purchaser that this product will be free from defects in material or workmanship for a period of 2 years from date of manufacture when properly installed and under normal condition of use. Specifications subject to change without notice.

For more information on Robertson Worldwide products, visit [www.RobertsonLighting.com](http://www.RobertsonLighting.com)

1748 Independence Blvd, Bldg. A, Sarasota, FL 34234, [www.RobertsonLighting.com](http://www.RobertsonLighting.com)