

O15P

Ballast Type: Electromagnetic
 Input Voltage: 120Vac +5%, -10%
 Input Frequency: 60Hz

Starting Method: Preheat Start
 Lamp Connection: Series

Unit Color: Raw
 Unit Weight: 0.70 lbs.

ELECTRICAL SPECIFICATIONS:

Line Voltage (V)	Lamp Type	Lamp Wattage (W)	No. of Lamps	Line Current (A)	Input Power (W)	Power Factor	Max Current THD (%)	Current Crest Factor	Ballast Factor	Wiring Diagram
120	CFT13W/GX23, CFQ13W/GX23	13	1	0.28	16	≥0.50	≤15	≤1.7	0.95	101
120	F15T8	15	1	0.26	17	≥0.53	≤10	≤1.7	0.87	001
120	F15T12	15	1	0.28	18	≥0.52	≤10	≤1.7	0.87	001
120	F15T12	20	1	0.25	17	≥0.58	≤10	≤1.7	0.70	001

PERFORMANCE:

- Electromagnetic Reactor Type Ballast
- Series Operation
- Normal Power Factor
- Normal Ballast Factor
- Clamped Core and Coil
- Sound Rated A
- Meets ANSI Standard C82.1 for Ballast Requirements

APPLICATION:

- Maximum Case Temperature 194°F/90°C
- Maximum Ambient Temperature 104°F/40°C
- Minimum Starting Temperature 32°F/0°C
- Minimum Starting Temperature Linear: 50°F/10°C
- Remote Mounting 18 ft. Max. Lead Length, 18AWG

SAFETY/STANDARDS:

- UL/935 Listed (Class P, Type 1 Outdoor)
- RoHS Compliant
- No PCB's
- Auto Reset Thermal Protection

CASE STYLE: CS-01A

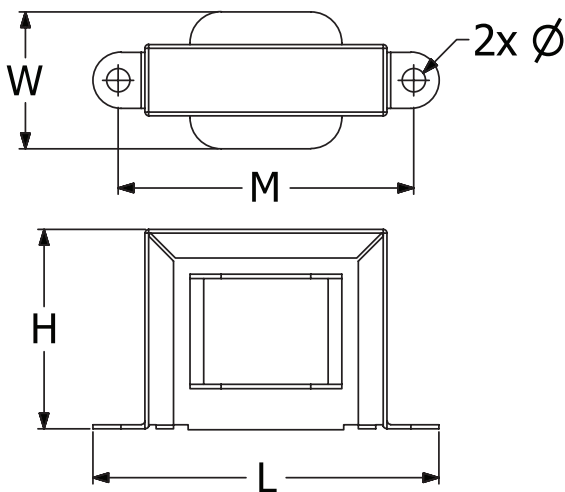

L	W	H	M	Ø
2-13/16	1-5/32	1-5/8	2-3/8	3/16
2.81	1.16	1.63	2.38	0.19
7.14 cm	2.94 cm	4.13 cm	6.03 cm	0.47 cm

WIRING DIAGRAM:

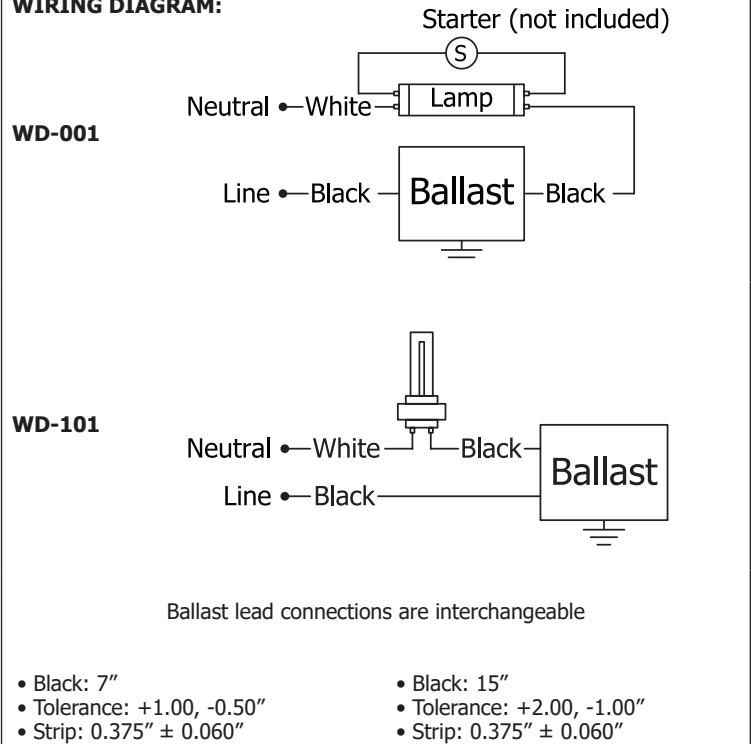

WARRANTY:

Robertson Worldwide warrants to the purchaser that this product will be free from defects in material or workmanship for a period of 2 years from date of manufacture when properly installed and under normal condition of use. Specifications subject to change without notice.

For more information on Robertson Worldwide products, visit www.RobertsonLighting.com